

Infrastructure and layout

The plan below shows the updated layout for the Westport Battery Energy Storage System.

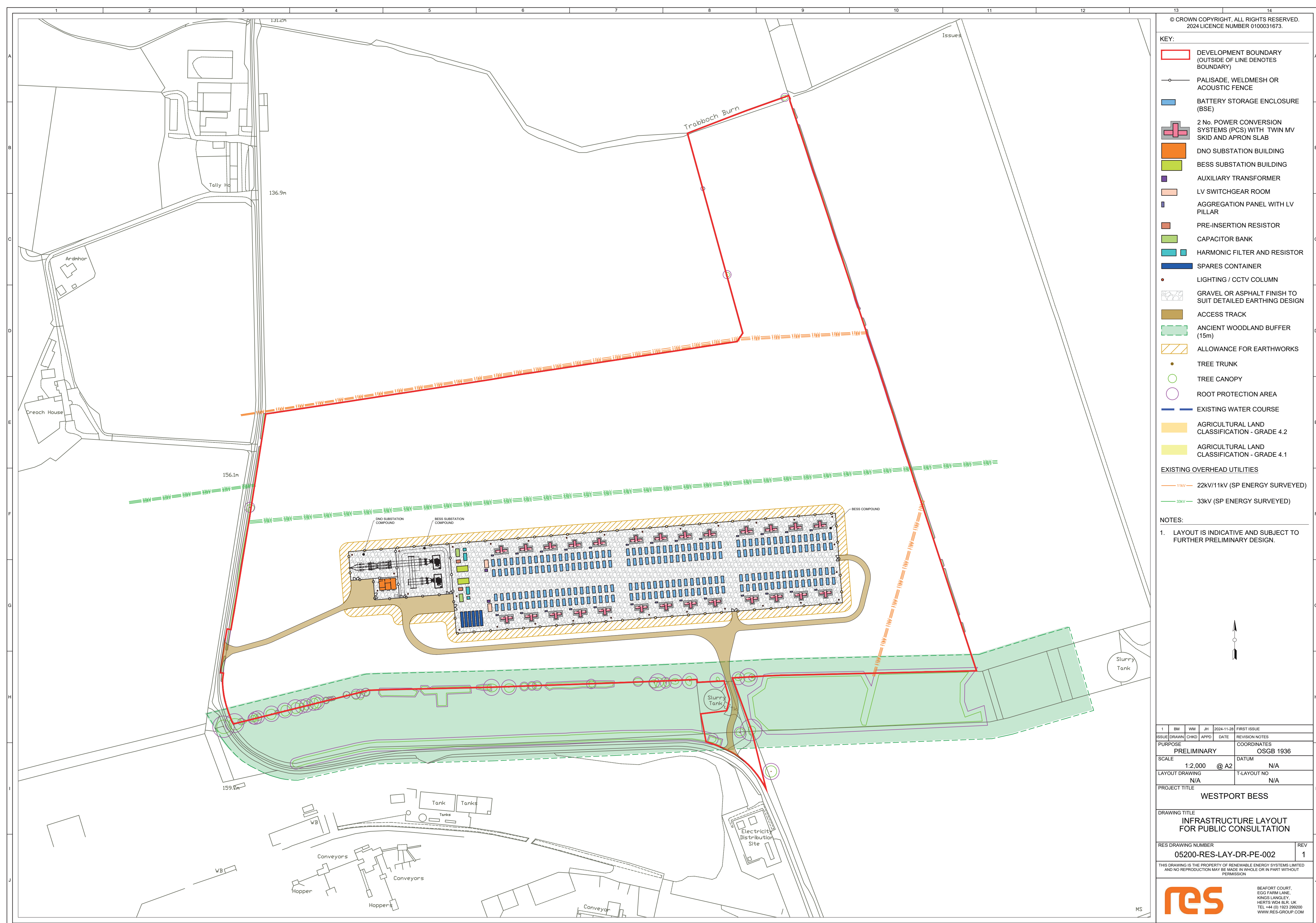

We are still consulting on the development boundary and as such, it is subject to change

The proposed system is a containerised scheme, involving proven Lithium iron phosphate (LFP) battery technology which RES has deployed at multiple projects around the world.

The site would comprise of approximately 200 battery containers. The typical dimensions of the battery containers are 6.1 metres long by 2.4m wide by 2.9 metres high.

The tallest infrastructure is expected to be the DNO substation which would have a maximum height of around 7.0 metres.

The infrastructure would include:

- Battery enclosures
- Power Conversion Systems and Transformers
- DNO Substation & grid infrastructure
- BESS Substation
- Auxiliary Transformer
- Grid Compliance Equipment
- Grid Connection Infrastructure
- Security System
- Landscaping
- Drainage Scheme